

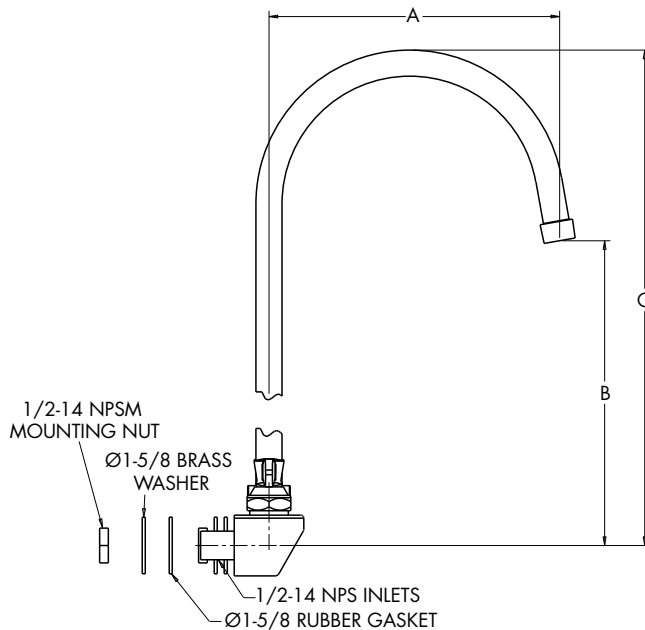

**SERVING YOU SINCE 1926**

KASON FOOD SERVICE 31-A AMLAJACK BLVD. NEWNAN, GA 30265  
1-800-935-2766 WWW.KASONIND.COM

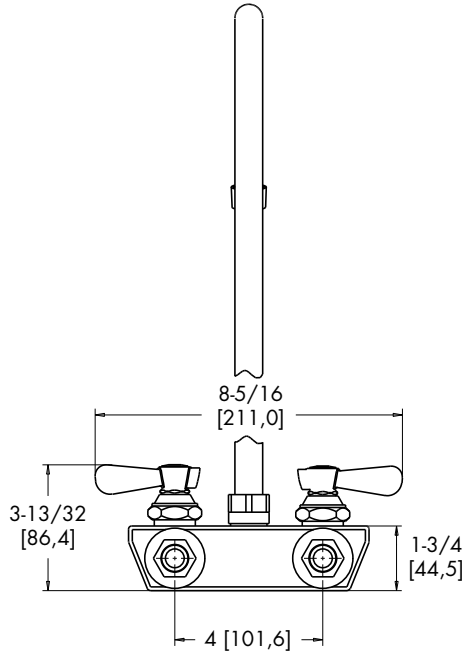

MODEL	DIM "A"	DIM "B"	DIM "C"
451KL4401	3-1/2"	5-1/8"	7-15/16"
451KL4402	6"	6-31/32"	11-1/16"
451KL4403	8-1/2"	8-23/32"	14-3/16"
ROUGH-IN: Ø 7/8" HOLES ON Ø 4" CENTERS			

APPLICATION:

JOB NAME:

QUANTITY:

SPECIFIER NO:

PRODUCT NAME: 4" HEAVY DUTY WALL MOUNT FAUCET



SPECIAL CONFIGURATION  
CHECK BASE MODEL AND OPTIONS

MODEL:



451KL4401 W/ 3-1/2" GOOSENECK SWIVEL SPOUT



451KL4402 W/ 6" GOOSENECK SWIVEL SPOUT



451KL4403 W/ 8-1/2" GOOSENECK SWIVEL

OPTIONS OR MODIFICATIONS:



SUPPLY LINES (24" OR  
36" CIRCLE LENGTH)



INLET KIT



NIPPLES



ELBOWS



VANDAL RESISTANT KIT



HANDLES: CROSS STYLE



HANDLES: WRIST STYLE



CERAMIC CARTRIDGE



LOW FLOW AERATOR



SPOUT EXTENTIONS



OTHER \_\_\_\_\_

FEATURES:

\*SPECIFICATION GRADE FAUCETS FOR YEARS OF DEPENDABLE PERFORMANCE.

\*RUGGED LOW LEAD BRASS ALLOY BODY WITH TRIPLE CHROME PLATE FINISH FOR LONG LIFE AND LOW MAINTENANCE.

\*LOW LEAD BRASS VALVE STEM AND SEAT USE URETHANE BIBB TYPE WASHER.

\*QUARTER TURN CERAMIC VALVES

\*BUILT-IN CHECK VALVES

MATERIALS:

\*LOW LEAD BRASS ALLOY VALVE BODY AND STEM.

\*POLISHED, TRIPLE CHROME PLATED VALVE BODY.

\*POLISHED CHROME FINISHED HIGH PRESSURE DIE-CAST ZINC HANDLES WITH STAINLESS STEEL SCREWS.

MOUNTING:

\*1/2"-14 NPS MALE INLETS

\*Ø 7/8" MOUNTING HOLES

\*4" CENTERS WITH MOUNTING HARDWARE

SYSTEM LIMITS:

\*TEMP: 40°F MIN. TO 140°F MAX

\*PRESSURE 200 PSI MAX. STATIC

\*1.80 GPM AT 80 PSI

**APPROVALS:**

**DATE:**

**GreenGuard®**





**SERVING YOU SINCE 1926**

KASON FOOD SERVICE 31-A AMLAJACK BLVD. NEWNAN, GA 30265  
1-800-935-2766 WWW.KASONIND.COM

APPLICATION:

JOB NAME:

QUANTITY:

SPECIFIER NO:

PRODUCT NAME: 4" HEAVY DUTY WALL MOUNT FAUCET

☐ SPECIAL CONFIGURATION  
CHECK BASE MODEL AND OPTIONS

MODEL:

- ☐ 451KL4406 W/ 6" SWIVEL SPOUT
- ☐ 451KL4408 W/ 8" SWIVEL SPOUT
- ☐ 451KL4410 W/ 10" SWIVEL SPOUT
- ☐ 451KL4412 W/ 12" SWIVEL SPOUT
- ☐ 451KL4414 W/ 14" SWIVEL SPOUT
- ☐ 451KL4416 W/ 16" SWIVEL SPOUT
- ☐ 451KL4418 W/ 18" SWIVEL SPOUT

OPTIONS OR MODIFICATIONS:

- ☐ SUPPLY LINES (24" OR 36" CIRCLE LENGTH)
- ☐ HANDLES: CROSS STYLE
- ☐ INLET KIT
- ☐ HANDLES: WRIST STYLE
- ☐ NIPPLES
- ☐ CERAMIC CARTRIDGE
- ☐ ELBOWS
- ☐ LOW FLOW AERATOR
- ☐ VANDAL RESISTANT KIT
- ☐ SPOUT EXTENTIONS
- ☐ OTHER \_\_\_\_\_

FEATURES:

- \*SPECIFICATION GRADE FAUCETS FOR YEARS OF DEPENDABLE PERFORMANCE.
- \*RUGGED LOW LEAD BRASS ALLOY BODY WITH TRIPLE CHROME PLATE FINISH FOR LONG LIFE AND LOW MAINTENANCE.
- \*LOW LEAD BRASS VALVE STEM AND SEAT USE URETHANE BIBB TYPE WASHER.
- \*QUARTER TURN CERAMIC VALVES
- \*BUILT-IN CHECK VALVES

MATERIALS:

- \*LOW LEAD BRASS ALLOY VALVE BODY AND STEM.
- \*POLISHED, TRIPLE CHROME PLATED VALVE BODY.
- \*POLISHED CHROME FINISHED HIGH PRESSURE DIE-CAST ZINC HANDLES WITH STAINLESS STEEL SCREWS.

MOUNTING:

- \*1/2"-14 NPS MALE INLETS
- \*Ø 7/8" MOUNTING HOLES
- \*4" CENTERS WITH MOUNTING HARDWARE

SYSTEM LIMITS:

- \*TEMP: 40°F MIN. TO 140°F MAX
- \*PRESSURE 200 PSI MAX. STATIC
- \*1.80 GPM AT 80 PSI

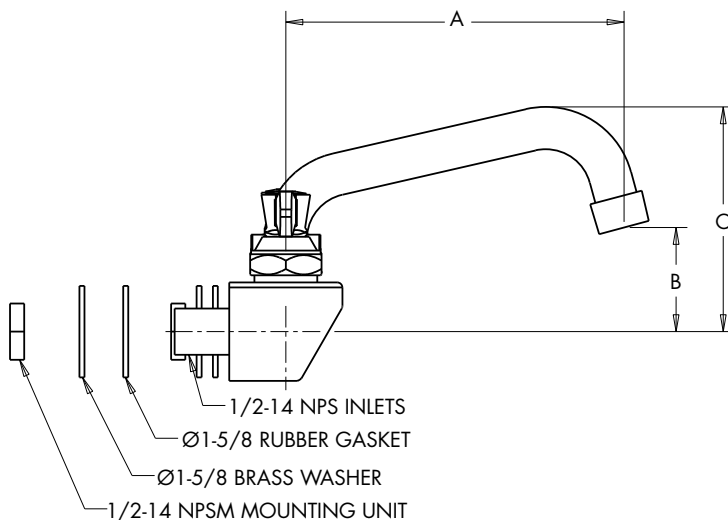
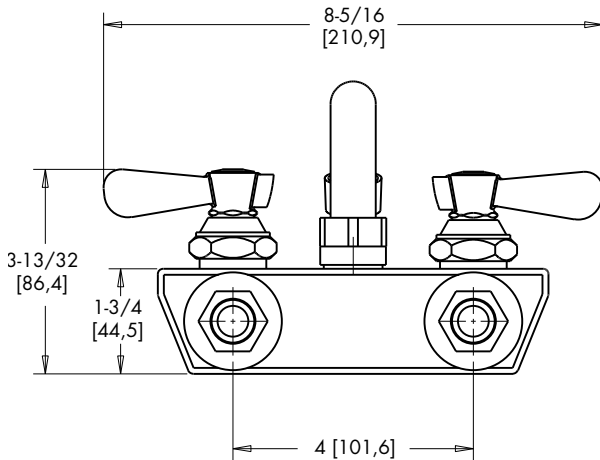

MODEL	DIM "A"	DIM "B"	DIM "C"
451KL4406	6"	1-27/32"	4"
451KL4408	8"	2-21/32"	4-3/4"
451KL4410	10"	3-17/32"	5-11/16"
451KL4412	12"	3-31/32"	6-3/32"
451KL4414	14"	4-15/32"	6-21/32"
451KL4416	16"	4-7/8"	7-1/32"
451KL4418	18"	5-13/32"	7-17/32"

ROUGH-IN: Ø 7/8" HOLES ON Ø 4" CENTERS

**APPROVALS:**

**DATE:**

**GreenGuard®**

